

MLLA-90-130-1-W-24V

Lighting Dimension

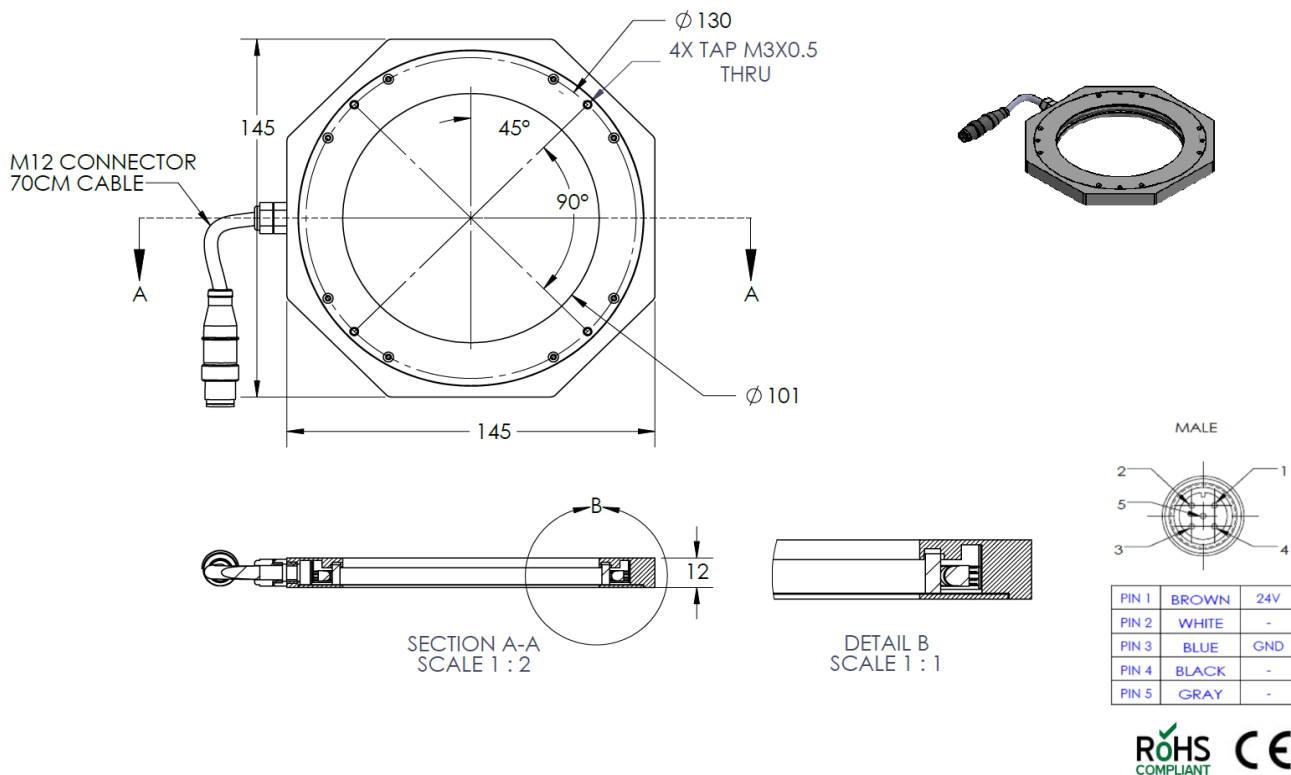

Mechanical Information	
Casing Material	Aluminium
Storage & Operating Temperature Range	Temp 0 - 45°C, Humidity 20-85%
Weight	265 g
Length / Outer Diameter	145 mm
Width / Inner Diameter	101 mm
Thickness / Height	12 mm



MLLA-90-130-1-W-24V

Optical Information																															
Part Number		MLLA-90-130-1-W-24V																													
LED Colour		WHITE																													
Wavelength	(nm)	* Refer to the Chromaticity Table Below																													
Intensity (±15%)	(Lux)	9632		9016		7560		6482																							
Working Distance	(mm)	6		11		16		21																							
Illumination (number of rows)		1																													
Illumination Active Area																															
Active Length / Outer Diameter	(mm)	101																													
Active Width / Inner Diameter	(mm)	N.A																													
Emission Angle	(deg.)	90																													
Eye Safety Class (IEC62471)		EXEMPT																													
*CHROMATICITY TABLE		<table><tr><td>X</td><td>0.296</td><td>0.287</td><td>0.307</td><td>0.311</td></tr><tr><td>Y</td><td>0.276</td><td>0.295</td><td>0.315</td><td>0.294</td></tr></table>					X	0.296	0.287	0.307	0.311	Y	0.276	0.295	0.315	0.294	<table><tr><td>X</td><td>0.311</td><td>0.307</td><td>0.33</td><td>0.33</td></tr><tr><td>Y</td><td>0.294</td><td>0.315</td><td>0.339</td><td>0.318</td></tr></table>					X	0.311	0.307	0.33	0.33	Y	0.294	0.315	0.339	0.318
X	0.296	0.287	0.307	0.311																											
Y	0.276	0.295	0.315	0.294																											
X	0.311	0.307	0.33	0.33																											
Y	0.294	0.315	0.339	0.318																											
Electrical Information																															
Lighting Supply Voltage (constant voltage mode)		24V ± 2%																													
Continuous Current	(mA)	280																													
Power Consumption	(W)	9.72																													
Lighting Casing Temperature, Operating after 60 minutes	°C	52.8																													
Strobe Mode Specification																															
Pulse Operation		YES																													
Max. Lighting Supply Voltage (constant voltage power supply)	(V)	Pulsing at 24VDC to 48VDC, 0-10% Duty Cycle, Recommended at 36VDC																													
Pulse Current, (Max. 10 msec) (constant current power supply)	(mA)	840																													
Max. Trigger Pulse Duration	(msec)	10																													
Duty Cycle		0-10%																													
Additional Information																															
Additional Cooling Method		Attached to machine part for better heat dissipation																													
Intensity Controller Selection		SD and SDA Series																													
CE Conformity		YES																													
RoHS Compliance		YES																													
Connection																															
Connector Type (default)		M12 5 PIN CONNECTOR (MALE)																													
Cable Length (out from lighting)	(mm)	700																													
Pin Configuration		Pin	Signal		Cable Colour																										
		1	24V		BROWN																										
		2	-		WHITE																										
		3	GND		BLUE																										
		4	-		BLACK																										
		5	-		GRAY																										
Extension Cable																															
Connector Type (default)		M12 5 PIN CONNECTOR (FEMALE)																													
Part Number		EXT-FL-M12F-3M-24V																													
Cable Length (out from female connector)	(mm)	3000																													
Extension Cable (connect to M12 5 Pin Male Connector from lighting)																															
Application																															
Illumination Type		Direct Illumination																													
Application Use		Edge detection, scratched on metal or glossy surface.																													