

MLLA-90-130-1-R-24V

Lighting Dimension

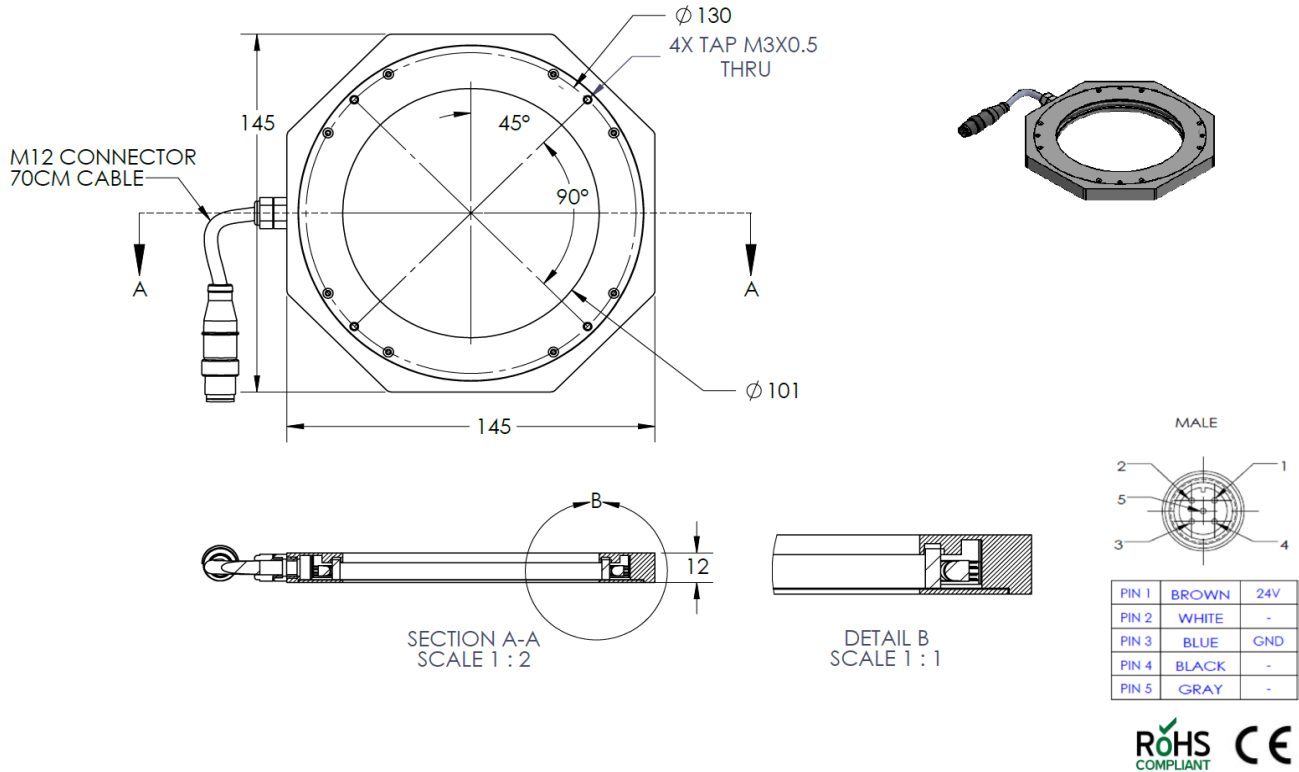

| Mechanical Information | |
|---------------------------------------|--------------------------------|
| Casing Material | Aluminium |
| Storage & Operating Temperature Range | Temp 0 - 45°C, Humidity 20-85% |
| Weight | 265 g |
| Length / Outer Diameter | 145 mm |
| Width / Inner Diameter | 101 mm |
| Thickness / Height | 12 mm |



MLLA-90-130-1-R-24V

| Optical Information | | | | | |
|--|--------|---|--------|--------------|------|
| Part Number | | MLLA-90-130-1-R-24V | | | |
| LED Colour | | RED | | | |
| Wavelength | (nm) | 630 | | | |
| Intensity (±15%) | (Lux) | 4872 | 4452 | 3640 | 3206 |
| Working Distance | (mm) | 6 | 11 | 16 | 21 |
| Illumination (number of rows) | | 1 | | | |
| Illumination Active Area | | | | | |
| Active Length / Outer Diameter | (mm) | 101 | | | |
| Active Width / Inner Diameter | (mm) | N.A | | | |
| Emission Angle | (deg.) | 90 | | | |
| Eye Safety Class (IEC62471) | | EXEMPT | | | |
| | | | | | |
| Electrical Information | | | | | |
| Lighting Supply Voltage (constant voltage mode) | | 24V ± 2% | | | |
| Continuous Current | (mA) | 210 | | | |
| Power Consumption | (W) | 5.04 | | | |
| Lighting Casing Temperature, Operating after 60 minutes | °C | 38.2 | | | |
| | | | | | |
| Strobe Mode Specification | | | | | |
| Pulse Operation | | YES | | | |
| Max. Lighting Supply Voltage (constant voltage power supply) | (V) | Pulsing at 24VDC to 48VDC, 0-10% Duty Cycle, Recommended at 36VDC | | | |
| Pulse Current, (Max. 10 msec) (constant current power supply) | (mA) | 630 | | | |
| Max. Trigger Pulse Duration | (msec) | 10 | | | |
| Duty Cycle | | 0-10% | | | |
| | | | | | |
| Additional Information | | | | | |
| Additional Cooling Method | | Attached to machine part for better heat dissipation | | | |
| Intensity Controller Selection | | SD and SDA Series | | | |
| CE Conformity | | YES | | | |
| RoHS Compliance | | YES | | | |
| | | | | | |
| Connection | | | | | |
| Connector Type (default) | | M12 5 PIN CONNECTOR (MALE) | | | |
| Cable Length (out from lighting) | (mm) | 700 | | | |
| Pin Configuration | | Pin | Signal | Cable Colour | |
| | | 1 | 24V | BROWN | |
| | | 2 | - | WHITE | |
| | | 3 | GND | BLUE | |
| | | 4 | - | BLACK | |
| | | 5 | - | GRAY | |
| | | | | | |
| | | | | | |
| Extension Cable | | | | | |
| Connector Type (default) | | M12 5 PIN CONNECTOR (FEMALE) | | | |
| Part Number | | EXT-FL-M12F-3M-24V | | | |
| Cable Length (out from female connector) | (mm) | 3000 | | | |
| Extension Cable (connect to M12 5 Pin Male Connector from lighting) | | | | | |
| | | | | | |
| Application | | | | | |
| Illumination Type | | Direct Illumination | | | |
| Application Use | | Edge detection, scratched on metal or glossy surface. | | | |