

MLLA-90-130-1-G-24V

Lighting Dimension

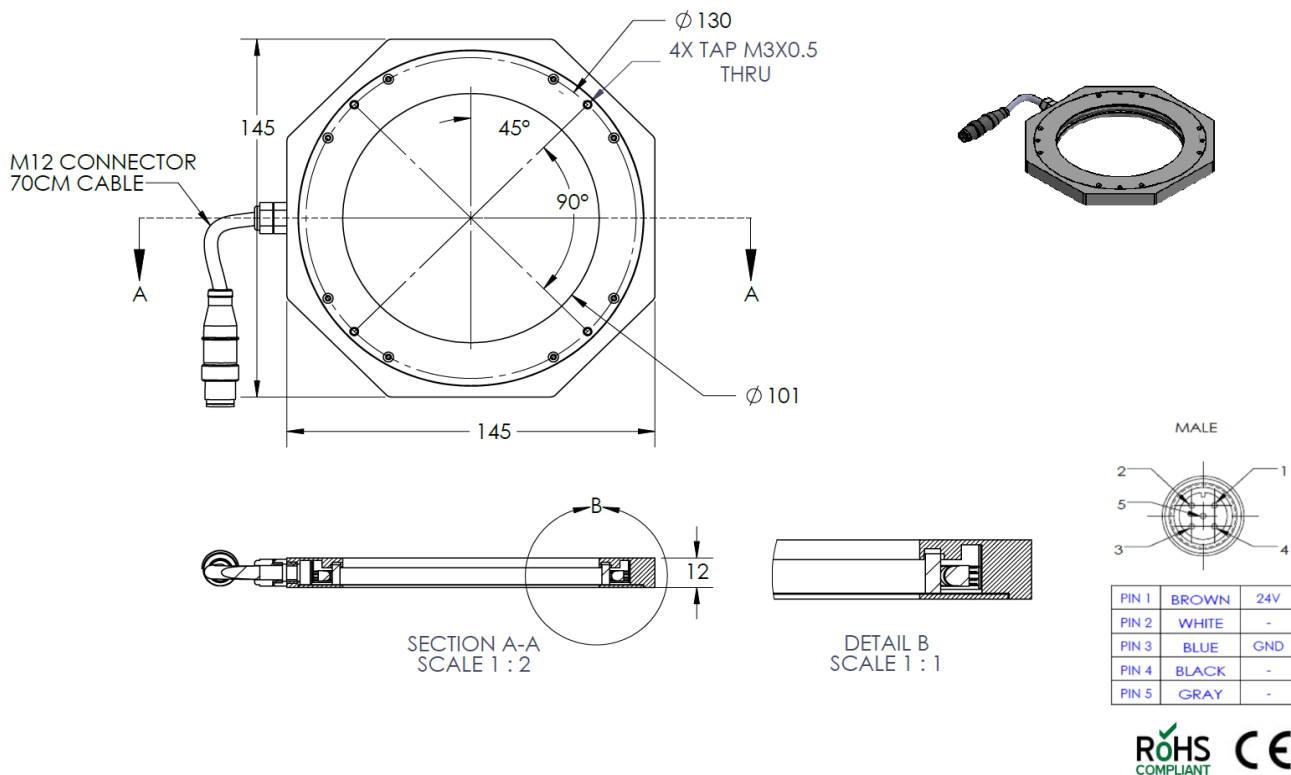

Mechanical Information	
Casing Material	Aluminium
Storage & Operating Temperature Range	Temp 0 - 45°C, Humidity 20-85%
Weight	265 g
Length / Outer Diameter	145 mm
Width / Inner Diameter	101 mm
Thickness / Height	12 mm



MLLA-90-130-1-G-24V

Optical Information					
Part Number		MLLA-90-130-1-G-24V			
LED Colour		GREEN			
Wavelength	(nm)	525			
Intensity (±15%)	(Lux)	9632	9016	7560	6482
Working Distance	(mm)	6	11	16	21
Illumination (number of rows)		1			
Illumination Active Area					
Active Length / Outer Diameter	(mm)	101			
Active Width / Inner Diameter	(mm)	N.A			
Emission Angle	(deg.)	90			
Eye Safety Class (IEC62471)		EXEMPT			
Electrical Information					
Lighting Supply Voltage (constant voltage mode)		24V ± 2%			
Continuous Current	(mA)	280			
Power Consumption	(W)	9.72			
Lighting Casing Temperature, Operating after 60 minutes	°C	52.8			
Strobe Mode Specification					
Pulse Operation		YES			
Max. Lighting Supply Voltage (constant voltage power supply)	(V)	Pulsing at 24VDC to 48VDC, 0-10% Duty Cycle, Recommended at 36VDC			
Pulse Current, (Max. 10 msec) (constant current power supply)	(mA)	840			
Max. Trigger Pulse Duration	(msec)	10			
Duty Cycle		0-10%			
Additional Information					
Additional Cooling Method		Attached to machine part for better heat dissipation			
Intensity Controller Selection		SD and SDA Series			
CE Conformity		YES			
RoHS Compliance		YES			
Connection					
Connector Type (default)		M12 5 PIN CONNECTOR (MALE)			
Cable Length (out from lighting)	(mm)	700			
Pin Configuration		Pin	Signal	Cable Colour	
		1	24V	BROWN	
		2	-	WHITE	
		3	GND	BLUE	
		4	-	BLACK	
		5	-	GRAY	
Extension Cable					
Connector Type (default)		M12 5 PIN CONNECTOR (FEMALE)			
Part Number		EXT-FL-M12F-3M-24V			
Cable Length (out from female connector)	(mm)	3000			
Extension Cable (connect to M12 5 Pin Male Connector from lighting)					
Application					
Illumination Type		Direct Illumination			
Application Use		Edge detection, scratched on metal or glossy surface.			