

## HBAQ-00-560X560-X-W-24V

### Lighting Dimension

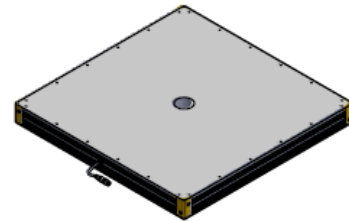
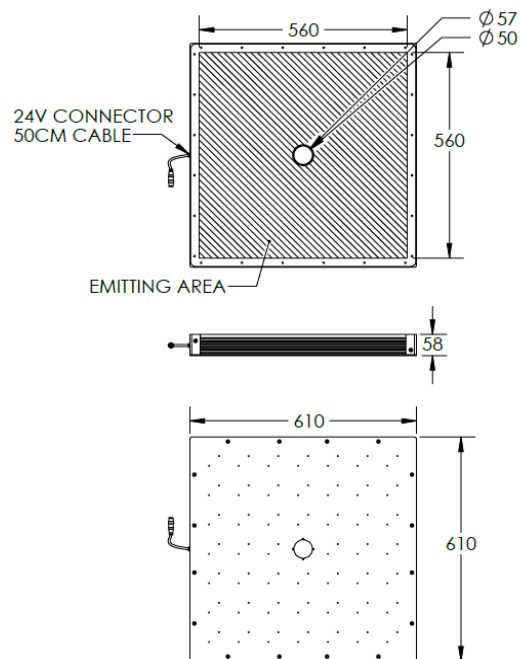

Mechanical Information	
Casing Material	Aluminium
Storage & Operating Temperature Range	Temp 0-60°C, Humidity 20-85%
Weight	10000 g
Length / Outer Diameter	610 mm
Width / Inner Diameter	610 mm
Thickness / Height	58 mm

## HBAQ-00-560X560-X-W-24V

Optical Information																															
Part Number		HBAQ-00-560X560-X-W-24V																													
LED Colour		WHITE																													
Wavelength	(nm)	* Refer to the Chromaticity Table Below																													
Intensity ( ±15%)	(Lux)	20000					18600					17200																			
Working Distance	(mm)	200					220					250																			
Illumination (number of rows)		X																													
Illumination Active Area																															
Active Length	(mm)	560																													
Active Width	(mm)	560																													
Emission Angle	(deg.)	0																													
Eye Safety Class ( IEC62471)		EXEMPT																													
*CHROMATICITY TABLE		<table><tr><td>X</td><td>0.296</td><td>0.287</td><td>0.307</td><td>0.311</td></tr><tr><td>Y</td><td>0.276</td><td>0.295</td><td>0.315</td><td>0.294</td></tr></table>					X	0.296	0.287	0.307	0.311	Y	0.276	0.295	0.315	0.294	<table><tr><td>X</td><td>0.311</td><td>0.307</td><td>0.33</td><td>0.33</td></tr><tr><td>Y</td><td>0.294</td><td>0.315</td><td>0.339</td><td>0.318</td></tr></table>					X	0.311	0.307	0.33	0.33	Y	0.294	0.315	0.339	0.318
		X	0.296	0.287	0.307	0.311																									
Y	0.276	0.295	0.315	0.294																											
X	0.311	0.307	0.33	0.33																											
Y	0.294	0.315	0.339	0.318																											
Electrical Information																															
Lighting Supply Voltage (constant voltage mode)		24V ± 2%																													
Continuous Current	(mA)	5760																													
Power Consumption	(W)	138.24																													
Lighting Casing Temperature, Operating after 60 minutes	°C	65.5																													
Strobe Mode Specification																															
Pulse Operation		YES																													
Max. Lighting Supply Voltage (constant voltage power supply)	(V)	Pulsing at 24VDC to 48VDC, 0-10% Duty Cycle Recommended at 36VDC																													
Pulse Current, (Max. 10 msec) (constant current power supply)	(mA)	17280																													
Max. Trigger Pulse Duration	(msec)	10																													
Duty Cycle		0-10%																													
Additional Information																															
Additional Cooling Method		Attached to machine part for better heat dissipation																													
Intensity Controller Selection		ANGX, SD and ST series																													
CE Conformity		YES																													
RoHS Compliance		YES																													
Connection																															
Connector Type (default)		M12 5 PIN CONNECTOR (MALE)																													
Cable Length (out from lighting)	( mm )	700																													
Pin Configuration		Pin	Signal				Cable Colour																								
		1	24V				BROWN																								
		2	-				WHITE																								
		3	GND				BLUE																								
		4	-				BLACK																								
		5	-				GRAY																								
Extension Cable																															
Connector Type (default)		M12 5 PIN CONNECTOR (FEMALE)																													
Part Number		EXT-FL-M12F-3M-24V																													
Cable Length (out from female connector)	(mm)	3000																													
Extension Cable (connect to M12 5 Pin Male Connector from lighting)																															
Application																															
Illumination Type		FRONT LIGHT WITH CENTER HOLE																													
Application Use		APPLICATION THAT INVOLVE WIDE FIELD OF VIEW AND REQUIRED UNIFORM LIGHTING																													