

## HBAX-00-560X560-X-G-24V

### Lighting Dimension

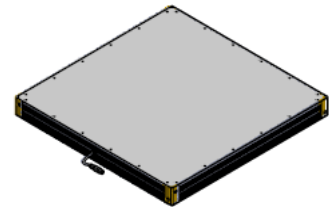

Mechanical Information	
Casing Material	Aluminium
Storage & Operating Temperature Range	Temp 0-60°C, Humidity 20-85%
Weight	10000g
Length / Outer Diameter	610 mm
Width / Inner Diameter	610 mm
Thickness / Height	58 mm

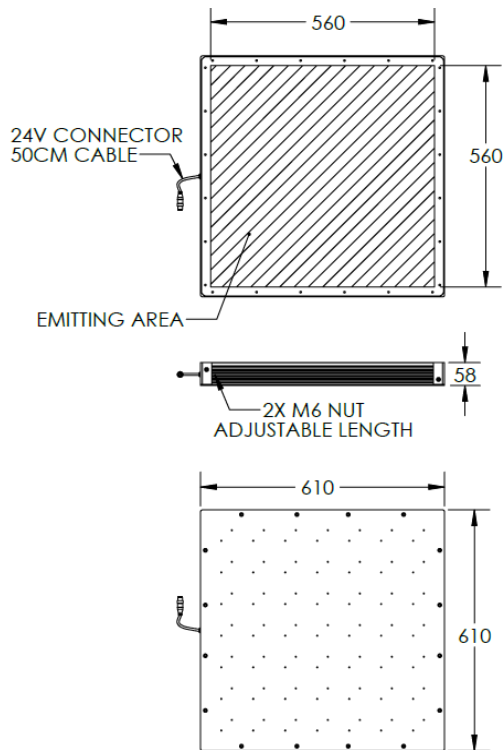

# PRE-ILLUMINATOR DATA

## HBAX-00-560X560-X-G-24V

Optical Information				
Part Number		HBAX-00-560X560-X-G-24V		
LED Colour		GREEN		
Wavelength	(nm)	525		
Intensity ( ±15%)	(Lux)	TBA	TBA	TBA
Working Distance	(mm)	10	20	30
Illumination (number of rows)		X		
Illumination Active Area				
Active Length	(mm)	560		
Active Width	(mm)	560		
Emission Angle	(deg.)	0		
Eye Safety Class ( IEC62471)		EXEMPT		
Electrical Information				
Lighting Supply Voltage (constant voltage mode)		24V ± 2%		
Continuous Current	(mA)	5880		
Power Consumption	(W)	141.12		
Lighting Casing Temperature, Operating after 60 minutes	°C	TBA		
Strobe Mode Specification				
Pulse Operation		YES		
Max. Lighting Supply Voltage (constant voltage power supply)	(V)	Pulsing at 24VDC to 48VDC, 0-10% Duty Cycle Recommended at 36VDC		
Pulse Current, (Max. 10 msec) (constant current power supply)	(mA)	17640		
Max. Trigger Pulse Duration	(msec)	10		
Duty Cycle		0-10%		
Additional Information				
Additional Cooling Method		Attached to machine part for better heat dissipation		
Intensity Controller Selection		ANGX, SD and ST series		
CE Conformity		YES		
RoHS Compliance		YES		
Connection				
Connector Type (default)		M12 5 PIN CONNECTOR (MALE)		
Cable Length (out from lighting)	( mm )	700		
Pin Configuration		Pin	Signal	Cable Colour
		1	24V	BROWN
		2	-	WHITE
		3	GND	BLUE
		4	-	BLACK
		5	-	GRAY
Extension Cable				
Connector Type (default)		M12 5 PIN CONNECTOR (FEMALE)		
Part Number		EXT-FL-M12F-3M-24V		
Cable Length (out from female connector)	(mm)	3000		
Extension Cable (connect to M12 5 Pin Male Connector from lighting)				
Application				
Illumination Type		HIGH INTENSITY BACKLIGHT		
Application Use		PROVIDES DIFFUSED BACK LIGHTING OVER A WIDE AREA		